



Sheraton Essen in Short

Effortless experiences and smarter stays make time for more exploration in unexpected surroundings.

UNEXPECTED SURROUNDINGS

The Sheraton Essen Hotel is privileged surrounded by the City Park and the Philharmonic Hall and in short walking distance to the city center, main train station and the popular restaurant and bar district along the Rüttenscheider Street.

Besides its industrial heritage the destination Essen is well known for its contemporary cultural program, featuring world known artists at cultural institutions like Folkwang Museum or the Aalto Theatre Opera House.

It transformed from an industrial headquarter to a modern city, presenting today highlights as the UNESCO World Heritage site Zeche Zollverein®, Villa Hügel and recreational areas like the Lake Baldeney.

STAY

The Sheraton Essen Hotel welcomes you in the city center of this Ruhr region metropolis. All 206 rooms and suites are modern in design and comfortably appointed, offering guests either park or city view. The hotel is a genuine component of the city's transformation, giving customers the possibility to relax in the very spacious rooms, recharging in Sheraton Sleep Experience® Beds, and experience the hotel and the city at their own pace.

FOOD & BEVERAGE

Taste our local and international dishes in the Bistro or Restaurant am Park, both offering a stunning view over the City Park.

The hotel bar is a popular meeting point and in the summer months, our terrace invites you to stay for a refreshing drink and seasonal cuisine.

MEET

The personal and private meeting space simplifies the whole process from booking and organizing to the realization of a seamless event in one of the four conference rooms with natural daylight and the latest technical equipment imaginative spaces set the scene for collaborative meetings.

THAT IS WHAT YOU HAVE TO SEE

- UNESCO-World Heritage Zeche Zollverein®
- Villa Hügel
- Lake Baldeney
- Philharmonic Hall Essen
- Aalto Theater Opera House
- GOP Varieté theatre
- Moviepark Germany



Sheraton Essen Hotel

Huyssenallee 55
45128 Essen, Germany
T +49 201 1007 0
sheratonessen.com

THE DETAILS

Guestrooms: 206
Minimum room size: 33 sqm

Categories:

- Standard City: 68
- Standard Park: 50
- Superior: 48
- Club Floor: 16
- Premium Club Floor: 13
- Suites: 11

FEATURES

- Restaurant am Park
- Bistro am Park
- Bar am Park
- Business Center
- 24h Fitness Center
- Wellness Area
- Sheraton Club Lounge

DISTANCES

City Center: 0.7 km
Main Station (Essen): 0.7 km
Fair Ground Essen / Gruga: 2 km
Fair Ground Düsseldorf: 30 km
International Airport Düsseldorf: 26 km





Sheraton Essen Hotel

Huysenallee 55
 45128 Essen, Germany
 T +49 201 1007 0
 sheratonessen.com

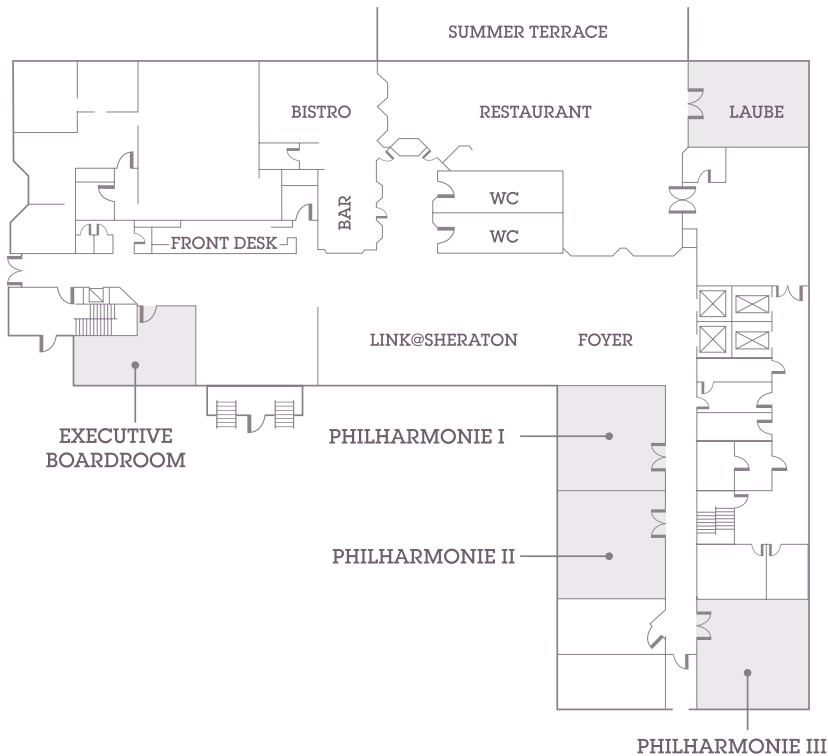

THE DETAILS

Meeting Spaces: 4
 Maximum Group Size: 100
 Total Meeting Space: 2,874 sq. ft. / 267 sq. mt.

FUNCTION SPACE GROUND FLOOR LEVEL

- 1 Philharmonie I&II
- 2 Philharmonie I
- 3 Philharmonie II
- 4 Philharmonie III
- 5 Executive Boardroom

	SQ FEET (ft ²)	SQ METERS (m ²)	DIMENSIONS (ft)	HEIGHT (ft)	RECEPTION	BANQUET	THEATER	CLASSROOM	U-SHAPE (outside)	SQUARE	DAYLIGHT
PHILHARMONY I&II	1,270	118	24.3' x 55.1'	9.8	100	84	90	60	42	42	YES
PHILHARMONY I	635	59	24.3' x 27.6'	9.8	50	48	45	25	24	20	YES
PHILHARMONY II	635	59	24.3' x 27.6'	9.8	50	48	45	25	24	20	YES
PHILHARMONY III	635	59	24.3' x 27.6'	9.8	50	48	45	25	24	20	YES
EXECUTIVE BOARDROOM	452	42	13.5' x 27.6'	9.8	-	-	-	-	-	16	YES
LAUBE	517	48	8.0 x 6.0	9.8	-	28	-	-	-	24	YES